



PALLET FORK

CLASS II & CLASS III



PALADIN LIGHT CONSTRUCTION

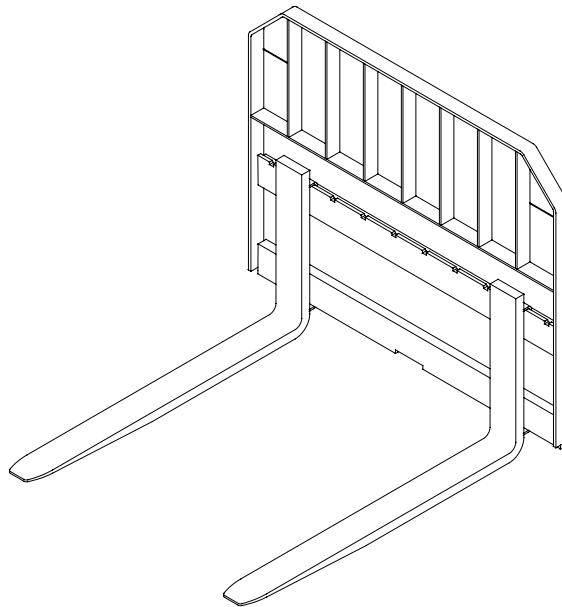

(LAF1137 Shown)

SERIAL NUMBER: _____

MODEL NUMBER: _____

Manual Number: MR45503
Models: LAF1108, LAF1135,
LAF 1136, LAF1137, LAF1138,
LAF1163, LAF1172, LAF1173,
LAF1175 and LAF1197;
10021, 10022 and 10047.
Date: April 10, 2006

TABLE OF CONTENTS

| | |
|---|-----|
| Introduction, General Information, Serial Number..... | 1 |
| Owner and Operator Safety Information..... | 2-5 |
| Definitions of Safety Terms and Symbols, Accident Prevention..... | 2 |
| Safety Instructions..... | 3-4 |
| Safety Signs..... | 5 |
| Power Unit Specifications, Mounting..... | 6 |
| Operation | 7-8 |
| Maintenance..... | 8 |
| Parts Illustration | 9 |
| Parts List, Specifications..... | 10 |
| Warranty | i |

INTRODUCTION

Congratulations on your purchase of a new **FFC Pallet Fork**. This product has been designed and built to lift stable objects vertically. You or any other person who will be assembling, operating, maintaining, or working with this product are required to read and completely understand the information and instructions contained in this manual. If anyone does not fully understand every part of this manual, please obtain further assistance by contacting the dealer from which this product was purchased or by contacting FFC at the telephone number or address listed on the cover of this manual. Keep this manual available for reference whenever this product is being handled or used. Provide this manual to any new owners and/or operators.

This manual covers model(s) **LAF1108: Utility Grade** and **LAF1135, LAF1136, LAF1137, LAF1138, LAF1163, LAF1172, LAF1173, LAF1175, LAF1197, 10022, 10047** and **10021: Construction Grade**. The difference between the models is the capacity, grade, and construction of the product, details of which are covered on the parts list and specifications page(s).

GENERAL INFORMATION

The purpose of this manual is to assist in assembling, mounting, operating, and maintaining your **Pallet Fork**. Read this manual carefully to obtain valuable information and instructions that will help you achieve years of safe and dependable service.

The illustrations and data used in this manual were current at the time of printing, but due to possible engineering and/or production changes, this product may vary slightly in detail. FFC reserves the right to redesign and/or change components as may be necessary without notification to anyone.

Throughout this manual, references may be made to:

- | | |
|--------------------------|---|
| Power Unit | The engine-driven machine to which this product must be attached. |
| Right, Left, Front, Rear | Directions that are determined in relation to the operator of the equipment when seated in the normal operating position. |
| | Precautions that must be followed to prevent damage to equipment. |
| | Precautions that must be followed to prevent substandard performance. |

IMPORTANT NOTICE

SERIAL NUMBER LOCATION

Always refer to the model and serial number when ordering parts or requesting information from your dealer. The serial number plate for this product is located **on the upper left area of the main back plate** of your **Pallet Fork**.

| | Reference Information |
|-----------------------------|-----------------------|
| Model Number _____ | Loader Make _____ |
| Serial Number _____ | Loader Model _____ |
| Date Purchased _____ | Loader Serial # _____ |

DEFINITION OF SAFETY TERMS AND SYMBOLS

Throughout this manual, the terms **DANGER**, **WARNING**, and **CAUTION** are used to indicate the degree of hazard to personnel if proper safety procedures are not followed. These words will be used in conjunction with the Safety Alert Symbol: a dark triangle containing a white exclamation mark.



The Safety Alert Symbol means:

ATTENTION! BECOME ALERT! YOUR SAFETY IS INVOLVED!

DANGER Indicates an imminently hazardous situation which, if not avoided, **WILL result in death or serious injury.**

WARNING Indicates a potentially hazardous situation which, if not avoided, **could result in death or serious injury.**

CAUTION Indicates a potentially hazardous situation which, if not avoided, **may result in minor or moderate injury;**

OR

may also be used to alert against unsafe practices that may result in personal injury.

ACCIDENTS CAN BE PREVENTED WITH **YOUR HELP !**

No accident prevention program can be successful without the wholehearted cooperation of the person who is directly responsible for the operation of the equipment.

To read equipment accident reports from all over the country is to be convinced that a large number of accidents can be prevented only by operators who consistently anticipate the results of their actions and thus prevent accidents from ever occurring. No power-driven equipment, whether it is on the highway, in a farm field, or in an industrial plant, can be any safer than is allowed by the person who is at the controls.

If accidents are to be prevented (and accidents can be prevented), that prevention will come from equipment operators who accept their complete responsibility.

The designer, the manufacturer, and the safety engineer all help create a safe product, but the operator of that product can wipe out their combined efforts with a single careless act.

The best safety device is a careful operator. FFC and your dealer ask that **YOU** be that careful, responsible equipment operator.

YOU ARE THE KEY TO SAFETY BECAUSE:

YOU are responsible for the SAFE operation and maintenance of **YOUR** Pallet Fork.

YOU are responsible to familiarize yourself, and anyone else who will assemble, operate, maintain, or work around this product, with the SAFETY information contained in this manual.

YOU are responsible to read ALL information contained in this manual to any operators or maintenance personnel who are not fully able to read the written English language. Whether **YOU** read the manual as written or translate it into another language, **YOU** must make certain that all operators and maintenance personnel have a complete understanding of the full and exact contents of this manual. Translations of this manual into other languages are available by submitting an order to FFC.

YOU can reduce the risk of injury or death by following all safety precautions and by using good safety practices.

SAFETY INSTRUCTIONS

WORK SAFELY - A CAREFUL OPERATOR IS THE BEST INSURANCE AGAINST ACCIDENTS !!

SECTION 1



WARNING

Obey all the safety instructions listed in this section and throughout this manual. Failure to obey instructions in this section could result in death or serious injury.

BEFORE ATTEMPTING ANY TYPE OF ASSEMBLY, OPERATION, MAINTENANCE, OR OTHER WORK ON OR NEAR THIS PRODUCT:

- **READ AND COMPLETELY UNDERSTAND THIS MANUAL.**
- **READ AND COMPLETELY UNDERSTAND THE MANUALS PROVIDED WITH YOUR *power unit, loader, and quick-attach.***
- Read and understand all safety signs on this product and on your power unit, loader, and quick-attach.
- Know all your controls and know how to quickly stop all power unit movement, the Pallet Fork movement, and the engine in case of an emergency.
- Know and obey all applicable government rules, O.S.H.A. regulations, local laws and other professional guidelines for your operation.
- Make sure that anyone who will be assembling, mounting, maintaining, repairing, removing, and/or storing this product:
 - has been instructed in the safe operation of this product and of the power unit, loader, and quick-attach to which this product is attached.
 - is physically and mentally capable of the safe operation of this type of equipment.
 - is not under the influence of drugs or alcohol.
 - is carefully supervised from a safe distance, especially if such person is inexperienced.
 - wears appropriate protective equipment (i.e. hardhat, safety glasses, work gloves, protective shoes, respirator, ear protection, etc.).
 - does not wear loose fitting clothing, loose or uncovered hair, or any accessories (jewelry, necktie, scarf, wrist watch, etc.) that can catch in moving parts.
 - has annually reviewed all safety instructions.
- Know and follow good work practices when assembling, mounting, maintaining, repairing, removing, and storing this product:
 - Work on a level surface in a well-lit area.
 - Keep the area clean and dry.
 - Use properly grounded electrical outlets & tools.

- Use the right tool for the job at hand.
- Make sure that your tools are in good condition for performing the desired function.
- When using tools, wear the protective equipment specified by the tool manufacturer. (i.e. hardhat, safety glasses, work gloves, protective shoes, etc.)

WHEN YOUR POWER UNIT IS USED DURING ANY TYPE OF ASSEMBLY, OPERATION, MAINTENANCE, OR OTHER WORK ON OR NEAR THIS PRODUCT:

- Before leaving the operator's station or before beginning any type of work on this product, lower this product to the ground, apply your power unit's parking brake, stop the engine, remove the starter key, wait for all moving parts to stop, and then relieve all pressure in the hydraulic lines. Refer to your power unit's operator's manual for instructions on how to relieve hydraulic pressure in lines.
- Know your loader's safe lifting and operating capacity and the weight of this product. See the specifications in this manual for the weight of this product and refer to your power unit's and your loader's operator's manuals for safe operating limits. Lift capacity may be reduced if using a quick-attach.
- Never allow anyone, except the operator, to be around the power unit or this product when either is in motion. Do not startup unless others are clear of the work area.
- Do not allow riders on this product or the power unit.
- Do not stand or climb on this product when raised.
- Do not place any part of your body under any part of this product unless this product is securely resting on adequate blocking or on the ground.
- Do not use blocking made of concrete blocks, logs, buckets, barrels or any other material that could suddenly collapse or shift positions. Do not use wood or steel blocking that shows any signs of material decay. Do not use blocking that is warped, twisted, or tapered.
- Never operate controls from the ground. Operate the controls only from the operator's station.
- Never leave equipment unattended with the engine running or with this product raised on the loader.
- Be aware of the added weight and width of this product. Reduce travel speeds accordingly, especially when traveling over rough ground.
- Keep this product close to the ground and under control when transporting.

SAFETY INSTRUCTIONS

WORK SAFELY - A CAREFUL OPERATOR IS THE BEST INSURANCE AGAINST ACCIDENTS !!

SECTION 1 (CONTINUED)



WARNING

Obey all the safety instructions listed in this section and throughout this manual. Failure to obey instructions in this section could result in death or serious injury.

WHEN MOUNTING THIS PRODUCT TO YOUR POWER UNIT:

- Refer to the operator's manuals of your power unit, your loader, and your quick-attach for special or detailed mounting instructions.
- This product should fit onto the quick-attach or loader arms of your power unit the same as the original products that were designed by your loader / quick-attach manufacturer.
- If this product does not fit properly, contact FFC before operating.
- Never place your finger into the mounting plate or loader holes. A slight movement of the power unit or this product could cause serious injury.

BEFORE EACH USE, THOROUGHLY INSPECT THIS PRODUCT AND:

- Make certain that all safety signs are in place and legible. Refer to the safety sign page in this manual for the placement of safety signs for this product.
- Replace all damaged or excessively worn parts and hardware only with genuine FFC parts or with properly rated fasteners.
- Make certain that all locking pins, latches, and connection devices are properly installed and secured.
- Make certain that all protective guards, canopies, doors, etc. are in place and secure.

WHEN OPERATING THIS PRODUCT IN ACCORDANCE WITH DESIGN INTENTIONS:

- Lift only objects that have solid bases that will rest securely on the forks. Objects with uneven, irregular, or rounded bases (especially round bales of forage) can easily tip off or roll off the forks on to the operator or others.
- Do not lift any object that is tall enough to extend above the top surface of the guard portion of the main back plate.
- Do not lift any unsecured or unbanded items that are small enough to fit through any of the openings in the guard portion of the main back plate.
- Keep the lifting surface of the forks level at all times while lifting any object.
- Do not roll back this product so far that the load falls off toward or on the operator.

WHEN ADJUSTING, SERVICING OR REPAIRING THIS PRODUCT:

- Make no modifications to your Pallet Fork.
- When making repairs, use only genuine FFC parts or, for fasteners, use only properly rated parts.
- Replacement parts, for parts with safety signs attached, must also have safety signs attached.

SECTION 2



CAUTION

Obey all the safety instructions listed in this section and throughout this manual. Failure to obey instructions in this section may result in personal injury.

- Never place your hands or fingers between the main back plate and a fork tooth, especially when repositioning a fork tooth.

SAFETY SIGN LOCATIONS

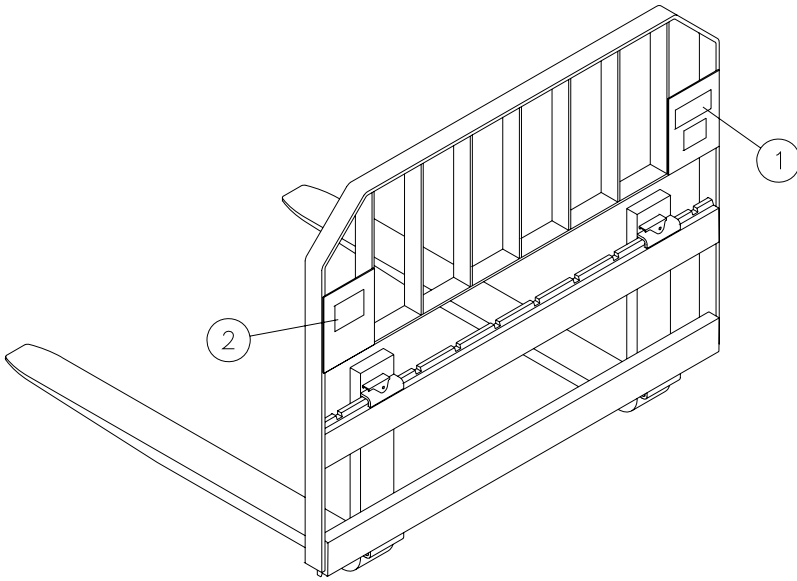

(LAF1137 Shown)

| ITEM | QTY. | PART # - DESCRIPTION |
|------|------|-----------------------|
| 1 | 1 | 50-0722 --Read Manual |
| 2 | 1 | RDL3126--Round Bale |
| 3 | 1 | RDL3254Serial Plate |

INSTRUCTIONS

- Keep all safety signs clean and legible.
- Replace all missing, illegible, or damaged safety signs.
- Replacement parts for parts with safety signs attached must also have safety signs attached.
- Safety signs are available, free of charge, from your dealer or from FFC.

PLACEMENT OR REPLACEMENT OF SAFETY SIGNS

1. Clean the area of application with non-flammable solvent, and then wash the same area with soap and water.
2. Allow the surface to fully dry.
3. Remove the backing from the safety sign, exposing the adhesive surface.
4. Apply the safety sign to the position shown in the diagram above and smooth out any bubbles.

ITEM 1

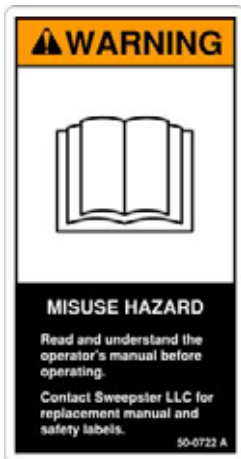

ITEM 2



ITEM 3

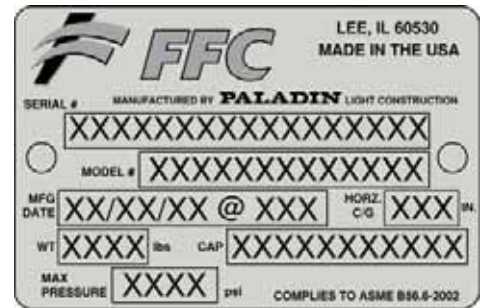

POWER UNIT SPECIFICATIONS

IMPORTANT

Exceeding any of the maximum recommended power unit specifications **CAN** result in damage to this product and **WILL** void all FFC warranties.

| DESCRIPTION | SPECIFICATIONS | | | |
|--------------------------------------|----------------|----------------|----------------|---------------------|
| Lift Capacity of Power Unit's loader | 3,000 | 3,750 | 5,500 | 10,000 lbs. maximum |
| Utility Grade | LAF1108 | | | |
| Construction Grade | | LAF1137 | LAF1135 | 10021 |
| | | LAF1138 | LAF1136 | 10022 |
| | | | LAF1163 | 10047 |
| | | | LAF1172 | |
| | | | LAF1173 | |
| | | | LAF1175 | |
| | | | LAF1197 | |

NOTE: The above models consist of seven Main Back plate frames. Several different forks may be used. See the parts list and specification pages for frame and fork descriptions.

| | |
|--------------|--|
| Rear Ballast | As required to maintain full power unit stability. (Note the Shipping Weight on page 10, then see the operator's manual(s) for your power unit, loader, and quick-attach for ballasting needs.) |
|--------------|--|

PALLET FORK MOUNTING



SAFETY FIRST!! READ AND UNDERSTAND THE SAFETY INSTRUCTIONS (pages 2-5 of this manual) BEFORE BEGINNING ANY PALLET FORK MOUNTING

1. Place this product on a firm, level surface that is large enough to safely accommodate this product, your power unit and all workers involved in the mounting process.
2. Refer to the operator's manual(s) for your power unit, loader, and quick-attach and follow the mounting instructions contained therein.
3. Carefully raise the loader and cycle the tilt cylinders to check clearances and to verify that all mounting procedures have been successfully completed.

PALLET FORK OPERATION



SAFETY FIRST!! READ AND UNDERSTAND THE SAFETY INSTRUCTIONS (pages 2-5 of this manual) BEFORE BEGINNING ANY PALLET FORK OPERATION

ADJUSTING THE FORK TEETH

The fork teeth should be adjusted to provide both:

- the maximum width allowable and
- the optimum stability of the load.

The fork teeth should be adjusted by:

1. Park your power unit on a level surface with this product properly attached.
2. Place your power unit's transmission in "Park" and engage the parking brake.
3. Completely lower the loader arms and fully roll the dump cylinders back toward the operator.
(NOTE: If the fork teeth are still in contact with the level surface after completing step 3, then raise the loader arms just enough to eliminate that contact.)
4. Shut off your power unit's engine, remove the starter key, and wait for all moving parts to come to a stop.



CAUTION

Failure to obey the following procedures may result in personal injury.

- **Never place your hands or fingers between the main back plate and a fork tooth, especially when repositioning a fork tooth.**

5. From the right side of your pallet fork, adjust the position of the right fork tooth.
 - Flip the latch on the top of the fork tooth so that the latch stays in the vertical position, then slide the fork tooth to the desired position by pushing or pulling high and low on the vertical portion of the fork tooth. Restore the latch to the horizontal position and make sure that the latch has been set in a notch.
6. Move to the left side of your pallet fork and repeat the adjustment process for the left fork tooth. Make sure that the left fork tooth is the same distance from the center of the main back plate as is the right fork tooth.

Maximum Load Permitted

The maximum loads lifted by these products shall never exceed the ALLOWABLE LOAD values. These ALLOWABLE LOAD values are the same as the "**Lift Capacity of Power Unit's loader**" values listed on page 6. The center of gravity of the ALLOWABLE LOADS must be applied within the first 24" of the fork teeth when measured from the front face of the vertical section of the fork teeth out toward the tip of the horizontal section of the fork teeth.

IMPORTANT

Lifting a load heavier than the ALLOWABLE LOAD or centered farther than 24" out on the fork teeth CAN result in damage to this product and WILL void all FFC warranties.



SAFETY FIRST!! READ AND UNDERSTAND THE SAFETY INSTRUCTIONS (pages 2-5 of this manual) BEFORE BEGINNING ANY PALLET FORK OPERATION



WARNING

Failure to obey the following procedures could result in death or serious injury.

- Lift only objects that have solid bases that will rest securely on the forks. Objects with uneven, irregular, or rounded bases (especially round bales of forage) can easily tip off or roll off the forks on to the operator or others.
- Do not lift any object that is tall enough to extend above the top surface of the guard portion of the main back plate.
- Do not lift any unsecured or unbanded items that are small enough to fit through any of the openings in the guard portion of the main back plate.
- Keep the lifting surface of the forks level at all times while lifting any object.
- Do not roll back this product so far that the load falls off toward or on the operator.

IMPORTANT

Using a fork tooth or teeth to pry on any object
CAN result in damage to this product and
WILL void all FFC warranties.

POSITIONING THE LOAD

1. Approach the load so that the weight will be centered between the fork teeth. If the load has a heavy side, then that side should be closest to the main back plate rather than near the tips of the fork teeth.
2. Make certain that the fork teeth are completely under the load and are level.
3. Lift the load slightly and make sure that the load is secure. If the load appears to be unstable, lower the load, reposition the load to achieve full stability, and repeat steps 2 and 3 until full stability is achieved.

TRANSPORTING THE LOAD

1. Raise the load to the **minimum** height required for the terrain that must be crossed with the load.
2. Operate the power unit so that:
 - the load always remains level,
 - accelerating, turning, and braking are done very gradually,
 - and any obstacles, bumps, or holes in your intended path are avoided.
3. Frequently check the load to make sure that the load has not become unstable.

PALLET FORK MAINTENANCE



SAFETY FIRST!! READ AND UNDERSTAND THE SAFETY INSTRUCTIONS (pages 2-5 of this manual) BEFORE BEGINNING ANY PALLET FORK MAINTENANCE

BEFORE EACH USE

- Make sure that all nuts and bolts are in place and properly tightened.
- Make sure that all other fasteners are in place and are performing their specified function.
- Make sure that all safety signs are in place, are clean, and are legible.
(SEE THE SAFETY SIGN SECTION ON PAGE 5.)
- Replace any damaged parts and excessively worn parts.

PARTS ILLUSTRATION

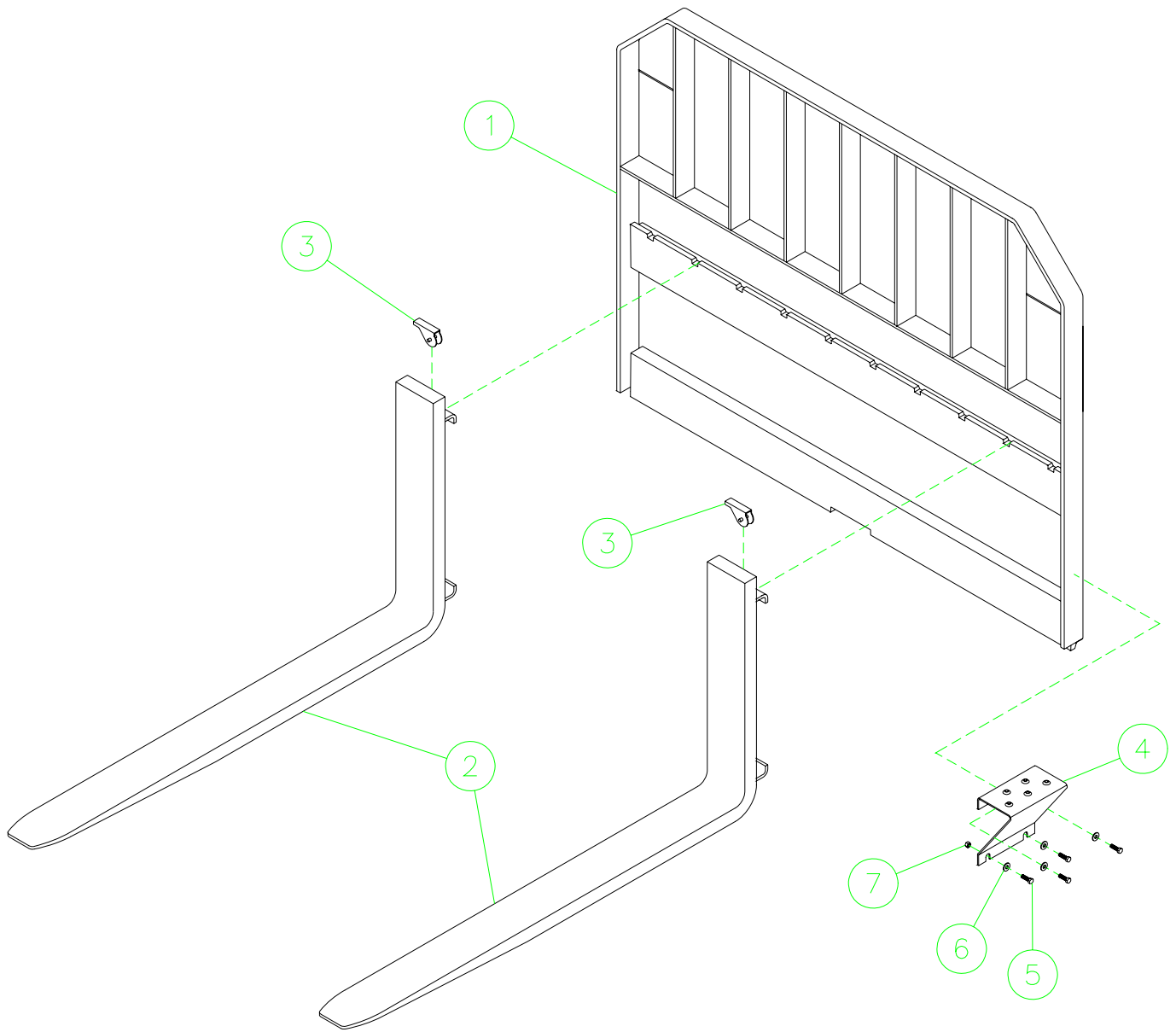

(LAF1137 Shown)

LAF1163 (or similar) ONLY

CLASS II PALLET FORK PARTS LIST

| ITEM | QTY. | LAF1108 | LAF1135 | LAF1136 | LAF1163 | DESCRIPTION |
|------|------|---|----------|----------|---------|--------------------------------|
| | | | LAF1137 | LAF1197 | LAF1172 | |
| | | | LAF1138 | | LAF1173 | |
| | | | LAF1175 | | | |
| 1 | 1 | LAF9464 | LAF1113 | LAF1153 | LAF1164 | Main Backplate |
| 2 | 2* | See List Below for Fork part numbers. | | | | Fork Tooth Weldment: Includes |
| 3 | 2 | Contact FFC to obtain the correct item. | | | | Latch Assembly |
| 4 | 2 | Not Used | Not Used | Not Used | LAF9949 | Step |
| 5 | 8 | Not Used | Not Used | Not Used | RHW1205 | H H Cap Screw: 3/8" x 1" Gr5 |
| 6 | 8 | Not Used | Not Used | Not Used | RHW5262 | Flat Washer: 3/8" Dia. USS |
| 7 | 8 | Not Used | Not Used | Not Used | RHW7203 | Locknut: 3/8" Dia. With 16 TPI |

*If Block Forks, 4 Forks included.

CLASS III PALLET FORK PARTS LIST

| ITEM | QTY. | 10022 | 10047 | 10021 | DESCRIPTION |
|---|------|---|----------|-------------------------------|--------------------------------|
| | | 48" | 60" | 72" | |
| 1 | 1 | 13-50191 | 13-51531 | 13-50185 | Main Frame Back plate Weldment |
| The following Forks are optional and sold as a separate line item: | | | | | |
| 2 | 2 | | 07-10052 | Tooth 2" x 5" x 42" OR | |
| | | | 07-10053 | Tooth 2" x 5" x 48" OR | |
| | | | 07-10015 | Tooth 2" x 5" x 60" | |
| 3 | 2 | Contact FFC to obtain the correct item. | | | Forks Include Latch Assembly |

*If Block Forks, 6 forks.

PALLET FORK SPECIFICATIONS

| Model Number | Fork Part Number | Overall Width | Overall Height | Overall Depth | Useable Fork Length | Fork Cross Section | Shipping Weight |
|--------------|------------------|---------------|----------------|---------------|---------------------|--------------------|-----------------|
| LAF1108 | LAF9467 | 42" | 36-1/2" | 44-1/2" | 36" | 1-1/8" x 4" | 330 lbs. |
| LAF1135 | LAF1106 | 47-3/4" | 41" | 51" | 48" | 1-3/4" x 4" | 600 lbs. |
| LAF1136 | LAF1106 | 60" | 38-3/4" | 51-13/16" | 48" | 1-3/4" x 4" | 612 lbs. |
| LAF1137 | LAF1105 | 47-3/4" | 41" | 44-1/2" | 42" | 1-1/4" x 4" | 457 lbs. |
| LAF1138 | LAF1109 | 47-3/4" | 41" | 50-1/2" | 48" | 1-1/4" x 4" | 491 lbs. |
| LAF1139 | LAF1105 | 46-1/4" | 40-3/4" | 44-1/2" | 42" | 1-1/4" x 4" | 420 lbs. |
| LAF1159 | LAF1109 | 46-1/4" | 40-3/4" | 50-1/2" | 48" | 1-1/4" x 4" | 440 lbs. |
| LAF1163 | LAF1106 | 47-3/4" | 40-3/4" | 58-9/16" | 48" | 1-3/4" x 4" | 600 lbs. |
| LAF1172 | LAF1128 | 47-3/4" | 40-3/4" | 70-9/16" | 60" | 1-3/4" x 4" | 648 lbs. |
| LAF1173 | LAF9696* | 47-3/4" | 40-3/4" | 58-9/16" | 48" | 2" x 2" | 518 lbs. |
| LAF1174 | LAF9695* | 47-3/4" | 40-3/4" | 52-9/16" | 42" | 2" x 2" | 505 lbs. |
| LAF1175 | LAF9696* | 47-3/4" | 41" | 51" | 48" | 2" x 2" | 505 lbs. |
| LAF1197 | LAF1128 | 60" | 38-3/4" | 63-13/16" | 60" | 1-3/4" x 4" | 660 lbs. |
| 10021 | | 72" | 42-3/4" | | | | 593 lbs. |
| 10022 | | 48" | 42-3/4" | | | | 460 lbs. |
| 10047 | | 60" | 42-3/4" | | | | 527 lbs. |
| | 07-10052 | | | 45-5/8" | 42" | 2" x 5" | 310 lbs. |
| | 07-10053 | | | 51-5/8" | 48" | 2" x 5" | 350 lbs. |
| | 07-10015 | | | 63-5/8" | 60" | 2" x 5" | 415 lbs. |

*Block Forks.



PALADIN LIGHT CONSTRUCTION

Warranty Registration Form and Delivery Inspection Report

IMPORTANT! Warranty **Void** if card is not returned with 10 days.
All Applicable sections **must** be filled in.

This section to be filled out and signed by Dealer at time of delivery.

Warranty Registration

| | |
|----------------------------------|----------------------------------|
| Customer's Name _____ | Dealer's Name _____ |
| Address _____ | Address _____ |
| City _____ State _____ Zip _____ | City _____ State _____ Zip _____ |
| Phone _____ | CHECK ONE: |
| Loader / Tractor Model _____ | Construction Use _____ |
| Delivery Date _____ | Agricultural Use _____ |
| Model or Part # _____ | Landscape Use _____ |
| Serial # _____ | Other: _____ |

Dealer Inspection (check items applicable)

- | | |
|---|---|
| <input type="checkbox"/> All Decals installed (see operator's manual) | <input type="checkbox"/> Review Operating and Safety Instructions |
| <input type="checkbox"/> Hydraulic fittings tight and free of leaks | <input type="checkbox"/> Guards and covers in place and secure |
| <input type="checkbox"/> Fasteners tight | <input type="checkbox"/> Does Product Function Properly |

I have thoroughly instructed the buyer on the above described equipment. This review included: The Operator's manual content, equipment care, adjustments, safe operation and applicable warranty policy.

Date _____ Dealer's Rep. signature _____

This section to be completed and signed by the customer

| | 1 Excellent | 2 Good | 3 Average | 4 Unsatisfactory | 5 Poor |
|--------------------------------------|----------------|------------|--------------|---------------------|-----------|
| QUALITY ASSURANCE RATING | | | | | |
| Question: | | FFC | | Local Dealer | |
| Quality of Product: Appearance | | _____ | | _____ | |
| Construction | | _____ | | _____ | |
| Quality of Service | | _____ | | _____ | |
| Value (Priced Fairly) | | _____ | | _____ | |
| Does it perform as claimed | | _____ | | _____ | |

The above described equipment and Operator's Manual have been received by me and I have been thoroughly instructed as to care, adjustments, safe operation and applicable warranty policy.

Date: _____ Owner's signature _____

NOTE! Make one copy each for the dealer's and owner's records. Mail original to FFC Attachments.



PALADIN LIGHT CONSTRUCTION

FFC LIMITED 12 MONTH WARRANTY

Thank you for purchasing a FFC product. Warranty protection is valid only when this Warranty Registration is completed and signed by the customer and dealer, and mailed to FFC. I hereby acknowledge that I have received a copy of the owners Limited Warranty and I accept the terms therein.

For a period of 12 months from date of delivery of product to the original user, FFC, warrants each product to be free from manufacturing defects, subject to the limitations contained in this policy.

This warranty does not apply to defect caused, in whole or in part, by unreasonable use while in the possession of the user, including, but not limited to: failure to properly set up product; failure to provide reasonable and necessary maintenance; normal wear; routine tune ups or adjustments; improper handling or accidents; operation at speed or load conditions contrary to published specification; improper or insufficient lubrication; improper storage. This warranty is also not a guarantee that the performance of each product will meet the expectations of the purchaser.

FFC shall not be liable for consequential damages of any kind, including, but not limited to: consequential labor costs or transportation charges in connection with the replacement or repair of defective parts; lost time or expense which may have accrued because of said defects. In no event shall FFC, Inc.'s total liability hereunder exceed the product purchase price.

FFC makes no warranty with respect to trade accessories or any component or accessory of the product which was not manufactured by FFC, including any purchased components on any kind. These are subject to the warranties of their respective manufacturers. The warranty will be considered void if the product or any part of the product is modified or repaired in any way not expressly authorized by FFC, or if closed components are disassembled prior to return. Closed components include, but are not limited to: gearboxes, hydraulic pumps, motors, cylinders, and actuators.

Our obligation under the warranty is expressly limited, at our option, to the replacement or repair at FFC, of Lee, Illinois, or at a service facility designated by us, or such part or parts as inspection shall disclosed to have been defective. We are not responsible for unauthorized repairs or replacements. Any implied or statutory warranties, including any warranty of merchantability or fitness for a particular purpose, are expressly limited to the duration of this written warranty. We make no other express or implied warranty, nor is anyone authorized to make any in our behalf. This warranty cannot be extended, broadened, or changed except in writing by an authorized officer of FFC.